

LAND & WATER RESOURCE MANAGEMENT COST SHARE PROGRAM REPORT

September 26, 2016

Cost share agreements to be constructed

Name	Cons. Practice	Money Committed
Harold King	Manure storage abandonment	\$7000.00
Total		\$7000.00

Cost share payments to landowners

Name	Cons. Practice	Actual Cost
William Baier	Well Abandonment	\$202.30
Gary Beal	Well Abandonment	\$357.00
Erv Butzlaff	WW, Critical Area Seeding	\$3678.85
Total		\$4238.15

Cost share agreements waiting to be signed

Name	Cons. Practice	Estimated Cost
Timothy Witek	WW, Critical Area Seeding	\$6790.00
Total		\$6790.00

Money Not Committed:

\$9471.85

LAND CONSERVATION DEPARTMENT BILLS & REVENUE

(BILLS)

OfficeMax - Miscellaneous Office Supplies	=	\$ 13.06
Two Landowners – Land & Water Cost Share Payments	=	\$ 4035.85
Wheeler’s Laura’s Lane Nursery – Down Payment for 2017 Small Packet Trees	=	<u>\$ 4810.00</u>
TOTAL =		\$ 8858.91

(REVENUE)

FPP Fees	=	<u>\$ 125.00</u>
TOTAL=		\$ 125.00

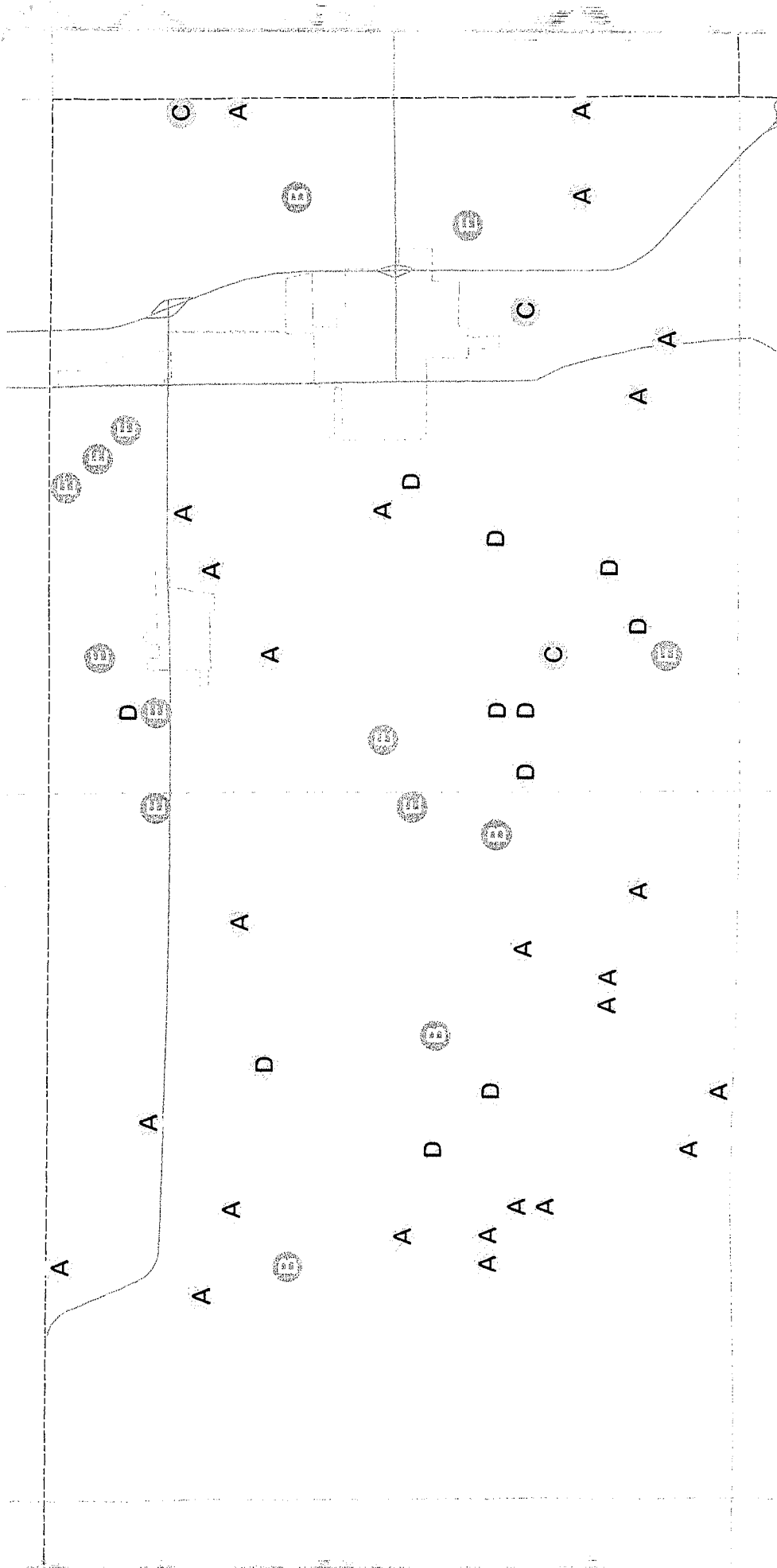

Leroy Lomira		Dodge County May 2016	
		NITRATE-NITRITE (ppm N)	
A	None Detected	31	48 %
B	... 2.0	6	9 %
C	2.1 - 5.0	3	5 %
D	5.1 - 10.0	9	14 %
E	10.1 - 20.0	16	25 %
F	20.1 ...	0	0 %

Mapped value is the average for the 1/4 1/4 section
 Treated samples not mapped

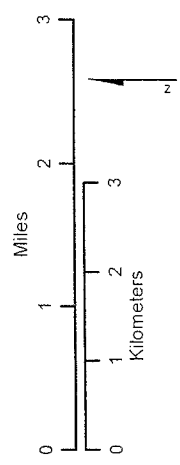

Center for Watershed Science and Education
 College of Natural Resources
 University of Wisconsin - Stevens Point

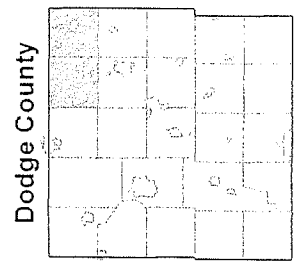

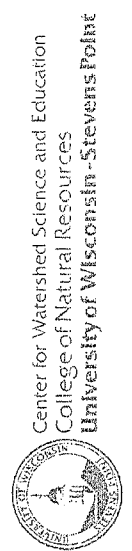
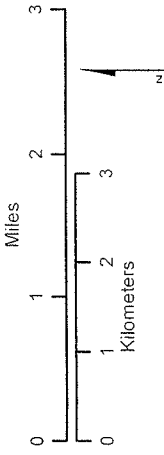
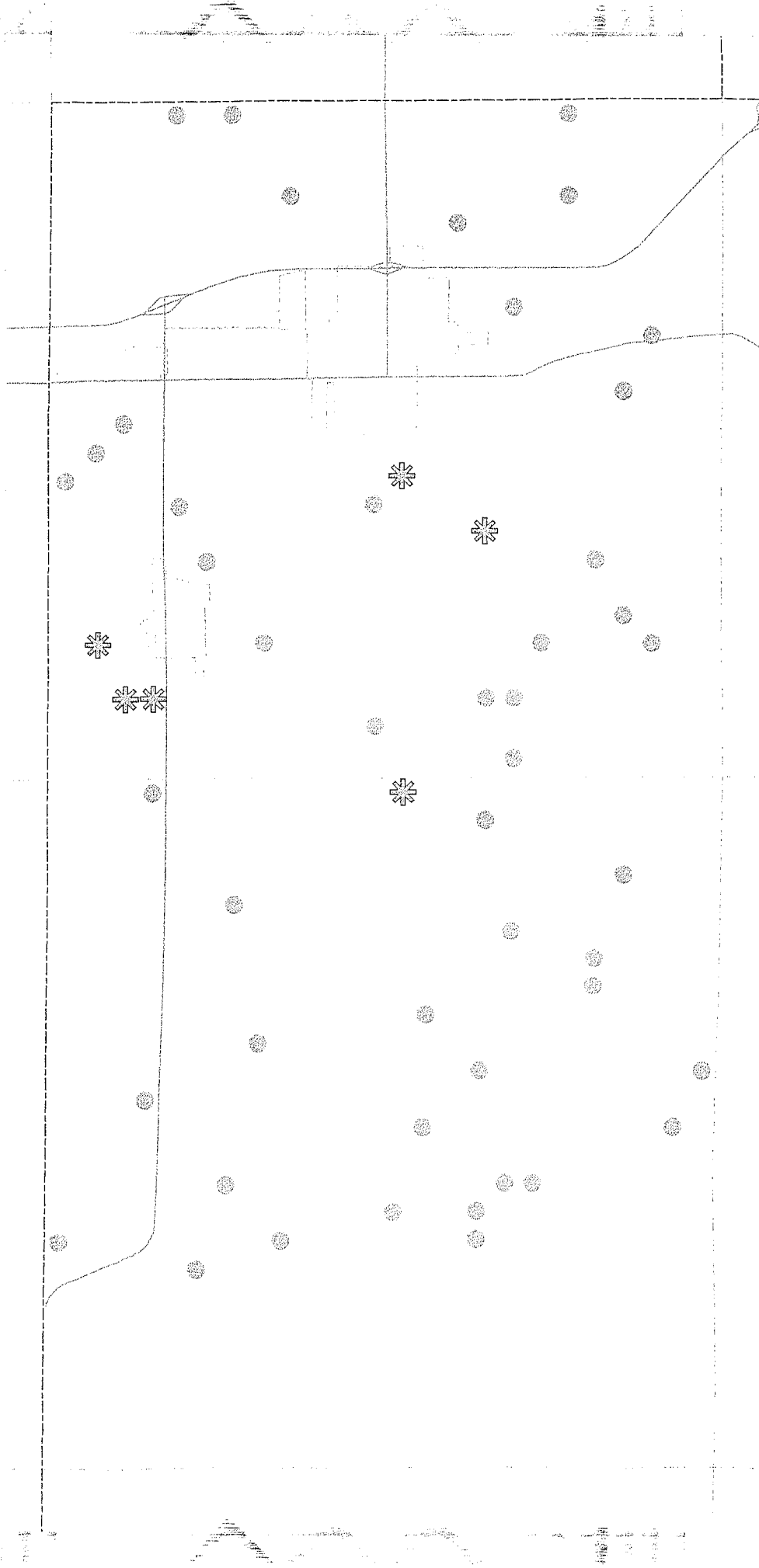

Dodge County

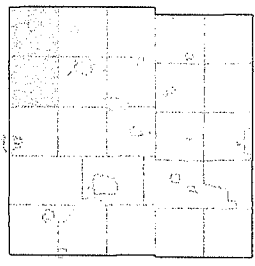

**Leroy
Lomira**
Dodge County
May 2016

*** BACTERIA POSITIVE**
Any sample in the 1/4 1/4 section

Summary

UWEX Private Well Project

Dodge County - LeRoy Lomira - 2016

8/30/2016

10:42 AM

Total Number Samples: 66

Sample Dates: 5/16/2016 to 5/16/2016

Reason for Test	Last Test (yr)	Problems	Treatment Sys	Depth (ft)	Well	Casing	Water	Well Diam (in)					
Curious	80 %	Never	6 %	Color	9 %	Softener	86 %	... 25	0 %	0 %	2 %	... 3	0 %
Problems	6 %	< 1	2 %	Taste	8 %	R/O	9 %	26-50	2 %	6 %	8 %	4 - 9	53 %
Regular	12 %	1 - 2	5 %	Odor	15 %	Carb Filt	9 %	51-100	0 %	14 %	12 %	10 - 18	0 %
Required	0 %	2 - 5	23 %	Corr	9 %	Neutral	3 %	101-150	12 %	3 %	3 %	18 +	0 %
Bac Retest	2 %	5 - 10	27 %	Health	2 %	Part Filt	15 %	151-200	11 %	3 %	5 %		
Disinfect	0 %	10 +	11 %	Other	8 %	Iron Filt	21 %	201 ...	24 %	15 %	11 %		
Infant...	0 %	Unk	20 %	None	52 %	Other	0 %						
Other	<1 %												

pH			Conductivity (umhos/cm)			Alkalinity (mg/L CaCO3)		
... 5.00	0	0 %	... 100	0	0 %	... 50	0	0 %
5.01 - 6.00	0	0 %	101 - 250	0	0 %	51 - 100	0	0 %
6.01 - 7.00	0	0 %	251 - 500	8	12 %	101 - 200	11	17 %
7.01 - 8.00	49	75 %	501 - 750	17	26 %	201 - 300	15	23 %
8.01 - 9.00	16	25 %	751 - 1000	27	42 %	301 - 400	39	60 %
9.01 ...	0	0 %	1001 ...	13	20 %	401 ...	0	0 %
Avg: 7.77	for	65 Samples	Avg: 963	for	65 Samples	Avg: 284	for	65 Samples

Total Hardness (mg/L CaCO3)			Nitrate (mg/L as N)			Chloride (mg/L)		
... 50	3	5 %	None Detected	31	48 %	None Detected	0	0 %
51 - 100	0	0 %	... 2.0	6	9 %	... 10	3	5 %
101 - 200	8	12 %	2.1 - 5.0	3	5 %	11 - 50	53	82 %
201 - 300	5	8 %	5.1 - 10.0	9	14 %	51 - 100	5	8 %
301 - 400	15	23 %	10.1 - 20.0	16	25 %	101 - 200	2	3 %
401 ...	34	52 %	20.1 ...	0	0 %	201 ...	2	3 %
Avg: 390	for	65 Samples	Avg: 4.7	for	65 Samples	Avg: 51.9	for	65 Samples

Saturation Index			Coliform Bacteria			Atrazine Screen* (ppb)		
... -3.0	0	0 %	Bact Samples	65		None Detected	35	67 %
-2.9 --2.0	0	0 %	Pos Bacteria	7	11 %	... 0.3	13	25 %
-1.9 --1.0	2	3 %				0.4 - 1.0	3	6 %
-0.9 -0.0	5	8 %	E. coli Bacteria			1.1 - 2.0	0	0 %
0.1 - 1.0	58	89 %	E. coli Samples	7		2.1 - 3.0	1	2 %
1.1 ...	0	0 %	Pos E. coli	0	0 %	3.1 ...	0	0 %
Avg: 0.4	for	65 Samples				Avg: 0.1	for	52 Samples

*Triazine screen before June 2008, then Diaminochlorotriazine (DACT).

Summary

UWEX Private Well Project

Dodge County - LeRoy Lomira - 2016

8/30/2016

10:42 AM

Total Number Samples: 66

Sample Date: 5/16/2016

Arsenic (mg/L)

None Detected	45	83 %
... 0.010	9	17 %
0.011 - 0.050	0	0 %
0.051 - 0.100	0	0 %
0.101 - 0.150	0	0 %
0.151 ...	0	0 %
Avg: <0.005 for	54 Samples	

Calcium (mg/L)

None Detected	4	7 %
... 25	16	30 %
26 - 50	7	13 %
51 - 75	2	4 %
76 - 100	16	30 %
101 ...	9	17 %
Avg: 58.5 for	54 Samples	

Copper (mg/L)

None Detected	5	9 %
... 0.130	26	48 %
0.131 - 0.500	16	30 %
0.501 - 0.900	3	6 %
0.901 - 1.300	1	2 %
1.301 ...	3	6 %
Avg: 0.228 for	54 Samples	

Iron (mg/L)

None Detected	22	41 %
... 0.300	24	44 %
0.301 - 1.000	6	11 %
1.001 - 2.000	1	2 %
2.001 - 5.000	0	0 %
5.001 ...	1	2 %
Avg: 0.387 for	54 Samples	

Potassium (mg/L)

None Detected	2	4 %
... 20	49	91 %
21 - 40	1	2 %
41 - 60	1	2 %
61 - 80	1	2 %
81 ...	0	0 %
Avg: 5.8 for	54 Samples	

Magnesium (mg/L)

None Detected	7	13 %
... 20	17	31 %
21 - 40	10	19 %
41 - 60	18	33 %
61 - 80	1	2 %
81 ...	1	2 %
Avg: 27.2 for	54 Samples	

Manganese (mg/L)

None Detected	16	30 %
... 0.050	36	67 %
0.051 - 0.300	2	4 %
0.301 - 0.500	0	0 %
0.501 - 1.000	0	0 %
1.001 ...	0	0 %
Avg: 0.011 for	54 Samples	

Sodium (mg/L)

None Detected	0	0 %
... 25	23	43 %
26 - 50	5	9 %
51 - 75	3	6 %
76 - 100	2	4 %
101 ...	21	39 %
Avg: 99.8 for	54 Samples	

Lead (mg/L)

None Detected	35	65 %
... 0.015	18	33 %
0.016 - 0.025	1	2 %
0.026 - 0.050	0	0 %
0.051 - 0.100	0	0 %
0.101 ...	0	0 %
Avg: 0.002 for	54 Samples	

Sulfate (mg/L)

None Detected	0	0 %
...25	11	20 %
26 - 50	13	24 %
51 - 75	10	19 %
76 - 100	4	7 %
101 ...	16	30 %
Avg: 131.7 for	54 Samples	

Zinc (mg/L)

None Detected	5	9 %
... 0.100	25	46 %
0.101 - 0.500	15	28 %
0.501 - 1.000	2	4 %
1.001 - 5.000	6	11 %
5.001 ...	1	2 %
Avg: 0.624 for	54 Samples	